

# Dead Centers FN / FNC

## Clamping tools for clamping on machine tools

Rotating and fixed tailstock spindle sleeve. Designed for employment in turning, grinding and other production machines.

made of full-hardened tool steel

➔ can be reground

### Type FN with morse taper

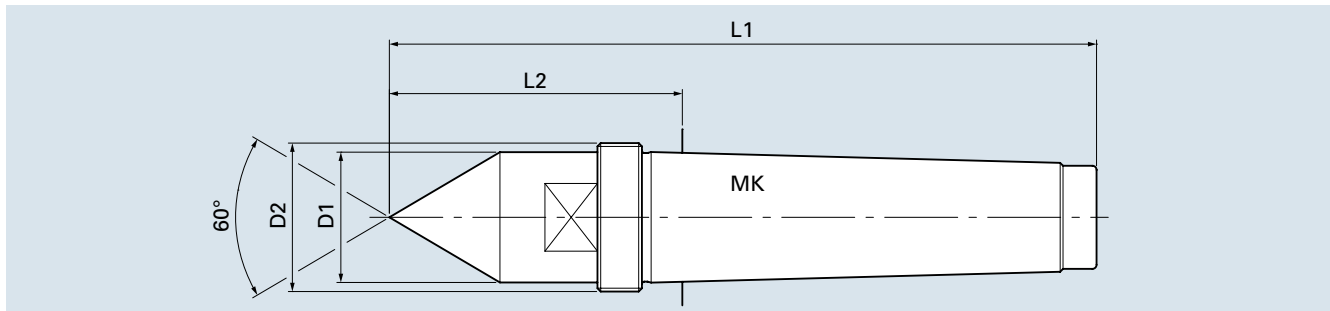

cat. no.	type	MK	D1	D2	L1	L2
92001	FN MK3	3	24	M27 x 1.5	138	57
92002	FN MK4	4	32	M36 x 1.5	175	72
92003	FN MK5	5	45	M48 x 1.5	217	87
92004	FN MK6	6	64	M68 x 1.5	290	108

● high true running accuracy max. 0.002

### Type FNC with morse taper



➔ extended working space

For better access of cutting tools in case of limited working space.

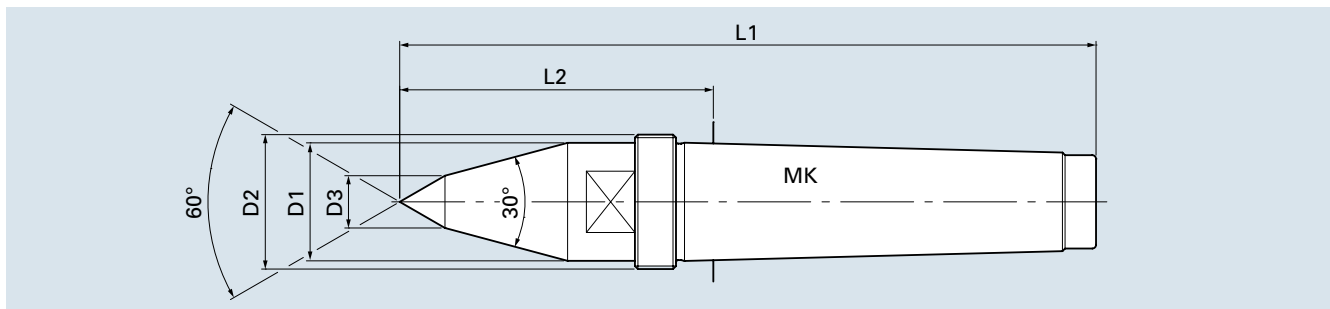

cat. no.	type	MK	D1	D2	D3	L1	L2
92101	FNC MK3	3	24	M27 x 1.5	10	148	67
92102	FNC MK4	4	32	M36 x 1.5	14	187	84
92103	FNC MK5	5	45	M48 x 1.5	16	242	112
92104	FNC MK6	6	64	M68 x 1.5	20	330	148

● high true running accuracy max. 0.002

All types with extracting thread to prevent spindle ball bearings or solid spindle sleeves from damage. Extracting nuts see page 19 for accessories.



## Dead Centers FNA / FNW

### Clamping tools for clamping on machine tools

→ for large work piece centers

High degree of flexibility for clamping of work pieces with large centers.

Different types of center cones from Ø25 to Ø315, see page 16.

Special center cones up to Ø400 available upon customer's request.

#### Type FNA with morse taper

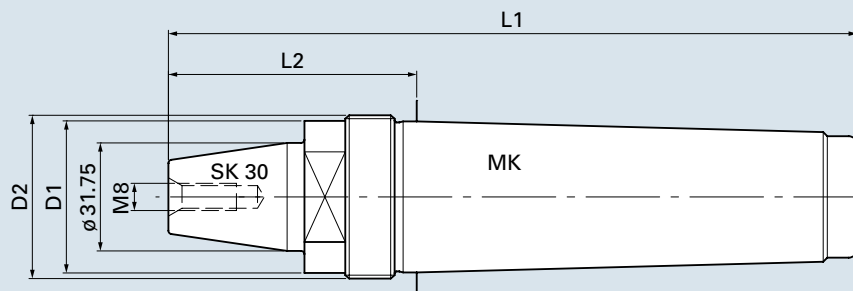

cat. no.	type	MK	D1	D2	L1	L2
92201	FNA MK3	3	32	M27 x 1.5	149	68
92202	FNA MK4	4	32	M36 x 1.5	173.5	71
92203	FNA MK5	5	45	M48 x 1.5	202.5	73
92204	FNA MK6	6	64	M68 x 1.5	263.5	81.5

● true running accuracy at center cone: max. 0.01

→ maximum flexibility

The adaptation of various changeable inserts ensures a high degree of flexibility and saving of costs.

Various changeable inserts of different designs, see page 17.

Special inserts available upon customer's request.

#### Type FNW with morse taper

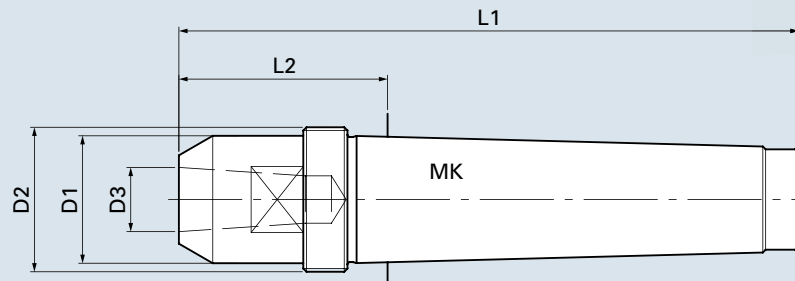

cat. no.	type	MK	D1	D2	D3	L1	L2
92301	FNW MK3	3	24	M27 x 1.5	16	121	40
92302	FNW MK4	4	32	M36 x 1.5	16	154.5	52
92303	FNW MK5	5	45	M48 x 1.5	22	190	60
92304	FNW MK6	6	64	M68 x 1.5	22	252	70

● true running accuracy at center cone: max. 0.01

Extracting nuts, see page 19 for accessories.

# Carbide Center Pins DIN 806

## Clamping tools for clamping on machine tools

**To be applied with hardened work pieces**  
For headstocks and fixed tailstock spindle sleeves.  
Designed for employment in grinding and other  
production machines.

### Type DIN 806 option model E/HE



### Type DIN 806 model E

with half carbide tip

cat. no.	MK	D1	D3	L1	L2
91001	1	12.2	7	80	26.5
91003	2	18	7	100	36
91006	3	24.1	11	125	44
91009	4	31.6	14	160	57.5
91012	5	44.7	18	200	70.5
91015	6	63.8	18	270	88

● hohe Rundlaufgenauigkeit: max. 0,002

### Type similar to DIN 806 model E

with full carbide tip

cat. no.	MK	D1	L1	L2
91002	1	12.2	80	26.5
91005	2	18	100	36
91008	3	24.1	125	44
91011	4	31.6	160	57.5
91014	5	44.7	200	70.5
91018	6	63.8	270	88

● high true running accuracy max. 0.002

### Type DIN 806 model HE

flattened with half carbide tip

cat. no.	MK	D1	D3	L1	L2	h
91101	1	12.2	7	80	26.5	1.5
91102	2	18	7	100	36	2
91104	3	24.1	11	125	44	3
91106	4	31.6	14	160	57.5	5
91108	5	44.7	18	200	70.5	7
91110	6	63.8	18	270	88	10

● high true running accuracy max. 0.002

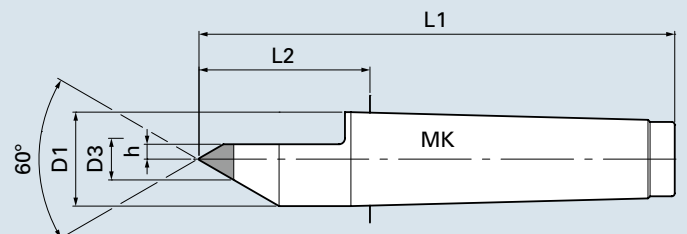
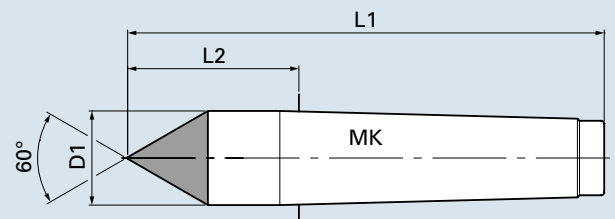
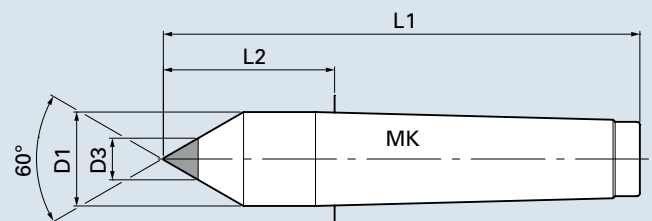



## Carbide Center Pins DIN 807

### Clamping tools for clamping on machine tools

#### → with extraction screw thread

DIN 807 with extraction screw thread to prevent spindle ball bearings or unpierced spindle sleeves from damage. Extracting nuts, see page 19 for accessories. Available with spanner flat upon request.

#### Type DIN 807 model E/HE

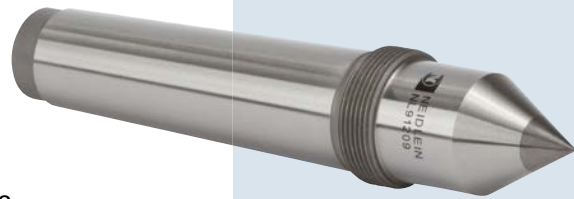

#### Type DIN 807 model E

with half carbide pin

cat. no.	MK	D1	D2	D3	L1	L2
91201	1	12.2	16 x 1.5	7	90	36.5
91203	2	18	22 x 1.5	7	112	48
91206	3	24.1	27 x 1.5	11	138	57
91209	4	31.6	36 x 1.5	14	175	72.5
91212	5	44.7	48 x 1.5	18	217	87.5
91215	6	63.8	68 x 1.5	18	290	108

● high true running accuracy max. 0.002

#### Type similar to DIN 807 model E

with full carbide pin

cat. no.	MK	D1	D2	L1	L2
91202	1	12.2	16 x 1.5	90	36.5
91205	2	18	22 x 1.5	112	48
91208	3	24.1	27 x 1.5	138	57
91211	4	31.6	36 x 1.5	175	72.5
91214	5	44.7	48 x 1.5	217	87.5
91218	6	63.8	68 x 1.5	290	108

● high true running accuracy max. 0.002

#### Type DIN 807 model HE

flattened with half carbide tip

cat. no.	MK	D1	D2	D3	L1	L2	h
91301	1	12.2	16 x 1.5	7	90	36.5	1.5
91303	2	18	22 x 1.5	7	112	48	2
91306	3	24.1	27 x 1.5	11	138	57	3
91309	4	31.6	36 x 1.5	14	175	72.5	5
91312	5	44.7	48 x 1.5	18	217	87.5	7
91315	6	63.8	68 x 1.5	18	290	108	10

● high true running accuracy max. 0.002

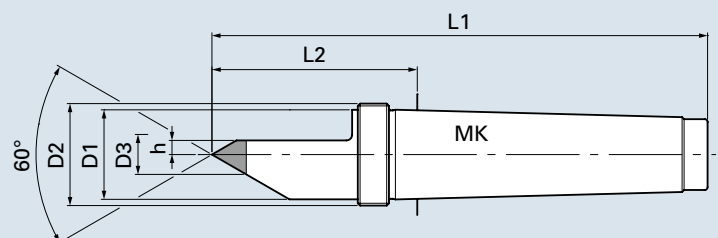
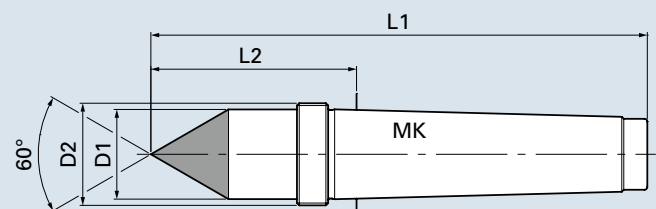
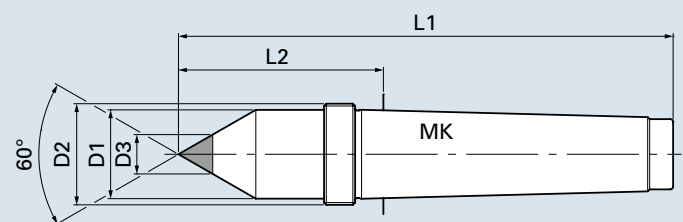

Extracting nuts, see accessories page 19.

## Changeable Center Cone for RNA / FNA

### Clamping tools for clamping on machine tools

#### Center cones for large work piece centers

High degree of flexibility for clamping of work pieces with large centers.

Suitable for live centers type RNA on page 6 and for dead centers type FNA on page 13.

Special cones up to  $\varnothing 400$  available upon customer's request.

For type RNA / FNA with SK30 interface



### For types RNA and FNA

cat. no.	W1	D1	D2	L
<b>81450</b>	60	20	85	60
<b>81451</b>	60	70	135	60
<b>81452</b>	60	120	185	60
<b>81453</b>	60	170	235	60
<b>81454</b>	60	220	285	60
<b>81455</b>	75	20	105	60
<b>81456</b>	75	90	175	60
<b>81457</b>	75	160	245	60
<b>81458</b>	75	230	315	60
<b>81459</b>	90	20	130	60
<b>81460</b>	90	100	210	60
<b>81461</b>	90	180	290	60

The center cones are fastened with a screw M8 DIN 912 onto the base body.

The center cones can be forced off with a screw M10.

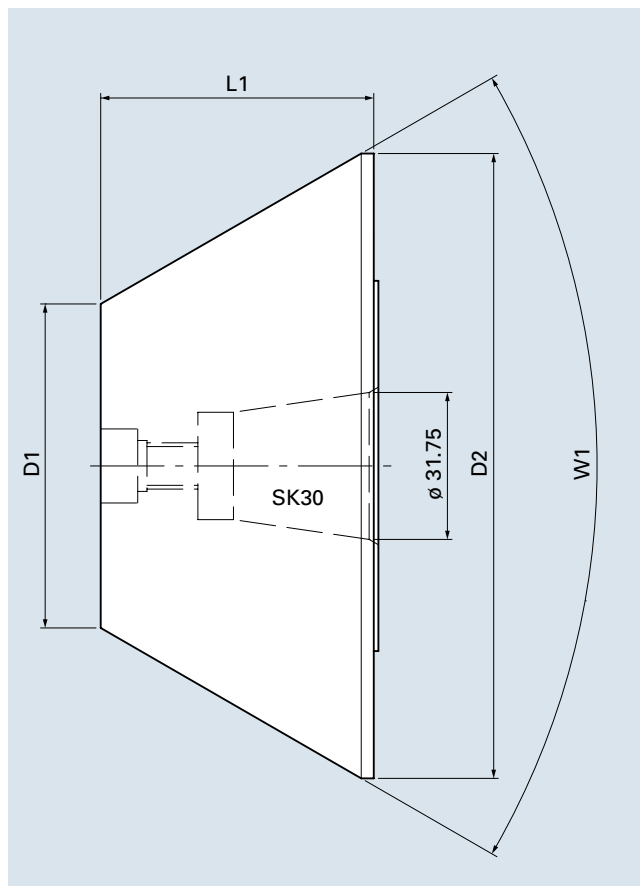



## Changeable Inserts for RNW / FNW

### Clamping tools for clamping on machine tools

#### Changeable inserts for a maximum of flexibility

The adaptation of various changeable inserts ensures a high degree of flexibility and saving of costs.

Suitable for live centers type RNW on page 7 and for the dead centers type FNW on page 13.

Special inserts available upon customer's request.

### For types RNW 3 and 4 FNW MK3 and 4

cat. no.	type	D1	D2	D3	D4	L
81550	A	22	-	-	16	30
81551	B	22	10	-	16	40
81552	C	22	7	10	16	30
81553	D	22	11	-	16	30
81554	E	55	21	-	16	35
81555	F	55	50	10	16	30
81556	G	22	10	-	16	40

### For types RNW 5 and 6 FNW MK5 and 6

cat. no.	type	D1	D2	D3	D4	L
81560	A	34	-	-	22	35
81561	B	34	16	-	22	45
81562	C	34	10	7	22	29
81563	D	34	18	-	22	35
81564	E	70	33	-	22	38
81565	F	70	64	24	22	34
81566	G	34	16	-	22	45

For type RNW / FNW with taper interface

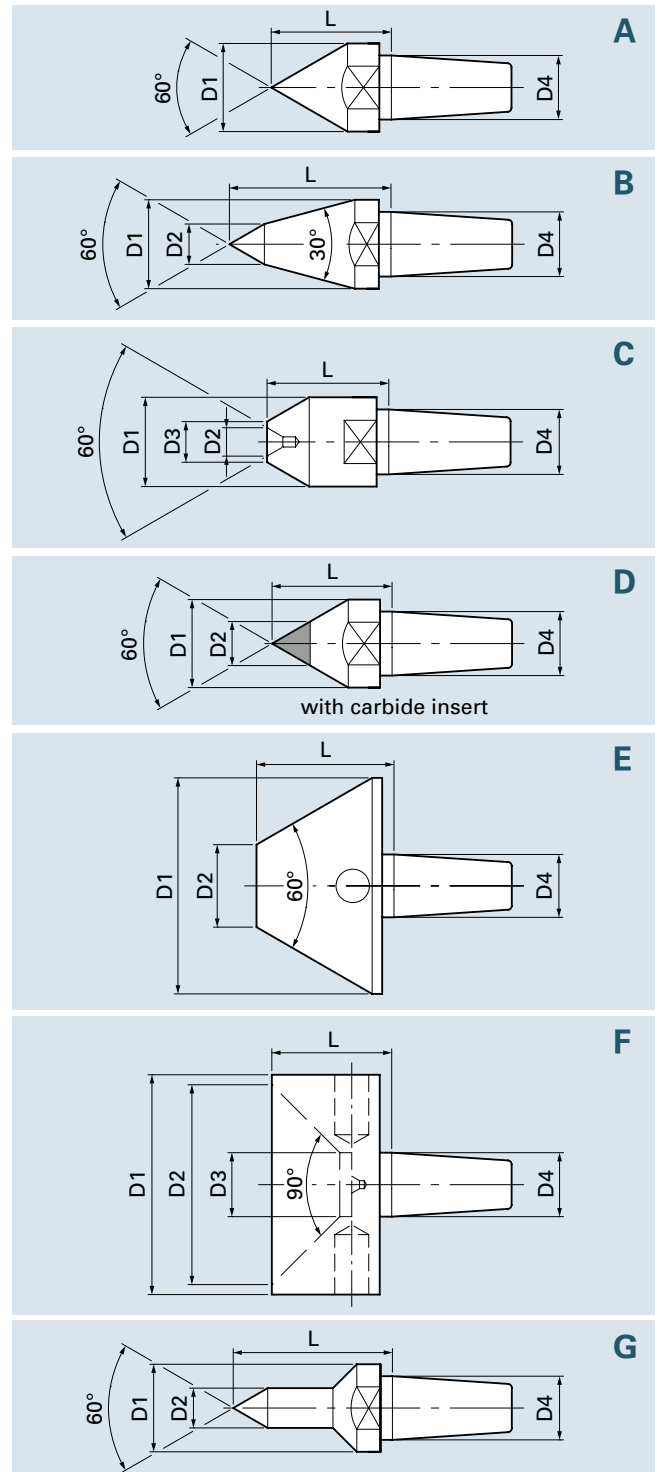

For quick demounting all changeable inserts come with spanner flat or cross hole.